

WuduMate Retail Thermostatic Mixing Valve



UNICLASS L721:N5352	EPIC H12:Y3107
CI/SfB (74.2)	(U35)

Specification Sheet (Metric)



Illustrated

WuduMate Retail Thermostatic Bathroom Mixer
Product Code WM-R-TMV

Material / Colour

Chrome

Installed with

WuduMate Compact

WuduMate Classic

Other appliances which require safe pre-mixed hot water

Special Notes

Maximum Inlet pressure static 10 bar

Minimum inlet pressure 0.25 bar

Init Temperature range Hot:55-65°C, Cold:<25°C

Factory pre-set temperature 38°C with max temp stop

Inlet connections G 1/2" M BSP (valve body)

Outlet connections G 1/2" BSP

Min temperature to achieve hot or cold fail safe 10°C

BS EN 1111 Working pressure range high pressure 0.5-5.0

Maximum pressure inlet differential 5:1

System installation Unvented, pressurised, gravity and combination boilers

NOTE: WRAS approved, TMV2 approved

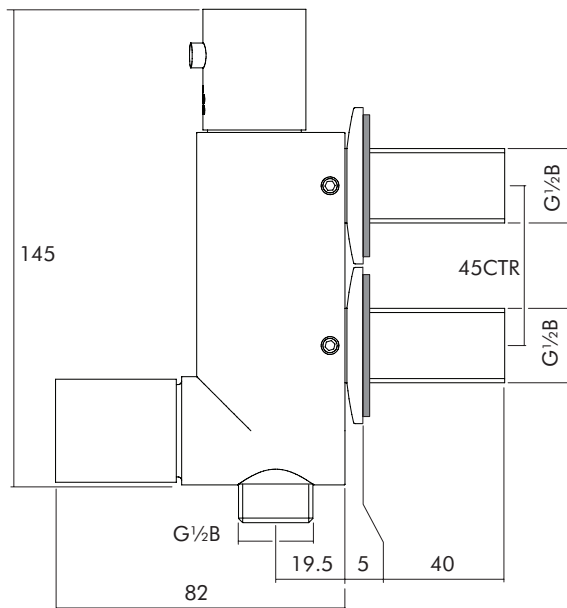

All dimensions in mm

The information in this specification sheet reflects the current technical specifications at the time of print. We reserve the right to change the technical or physical specifications without prior notice. All WuduMate images and symbols are exclusive property of Specialist Washing Co. Specialist Washing Co. accept no liability for loss or damage caused by improper installation. Any reproduction or retransmission or republication of any part of this specification sheet is strictly prohibited, unless prior written permission has been granted by Specialist Washing Co, E&OE.

WuduMate



+44 (0)1784 748080 • info@wudumate.com